

BOX-DR

Box ventilatori na direktan pogon sa dva otvora Direct drive double inlet box fans



BOX - DR

SEK. 8

OSNOVNI PODACI :

Ventilatori BOX -DR serije su dizajnirani za odvlačenje, filtraciju i održavanje vazduha .Važna karakteristika im je nizak nivo buke, što ih čini pogodnim za urbane sredine : (apartmane, kuće, barove, restorane, škole, kancelarije itd) i za industrijske pogone gde je visok nivo buke problem. Nizak nivo buke je dobijen zahvaljujući Plenum akustičnom materijalu koji omogućuje izuzetnu redukciju nivoa buke ,neizbežno proizvedenu od strane ventilatora.
Ventilator je unapred zakrivljena lopatica sa ugrađenim motorom i dva otvora.

KONSTRUKCIJA :

- BOX-DR : ram ventilatora je izrađen od livenog aluminijuma; oplata- stranice (koje su odvojive) izrađene su od galvanizovanog čelika ;u celini daje vrlo estetičan utisak.
- Vodootporni poklopac je izrađen od galvanizovanog čelika.
- Panel duplog sloja ,debljine 13 mm.
- Ventilator je fiksiran koristeći spoljne ivice i podupret odgovarajućim podupiračima sa strane ventilatora.
- Ventilator je kompletno izolovan od konstrukcije antivibracionim okvirom i izolacionim materijalom.
- Iznutra obložen Plenum-mom u Technopolymer- u klase I.
- Box ventilatori na direktan pogon sa dva otvora – motorom monofaznim ili trofaznim asinhronim, klase B pogodnim za regulaciju brzine (koristeći regulatore koji se prikazuju u ovom katalogu)
Sa odgovarajućim otvorima za podizače – držače.

DODATNI DELOVI :

- Elektronski i auto- transformirajući regulator brzine
- Nožni podupirač

NA ZAHTEV :

- Verzija sa asinhronim tro brzinskim motorom, klase B.
- Verzija sa totalno zatvorenim motorom , klase B.

GENERAL DESCRIPTION

The fans of the BOX-DR series are particularly designed for air extraction, filtration systems, air conditioning plants. Their main characteristic is the low noise level which makes them ideal for urban environments (apartments, houses, bar, restaurants, gymnasiums, offices) and industrial sites where the noise is a problem. The low noise level is due to their "lined plenum" of acoustic material that allows a remarkable reduction of the noise level inevitably generated by the fan. The fan is a double inlet forward curved centrifugal wheel with built-in motor.

CONSTRUCTION

- BOX/DR: frame in extruded aluminium profile; removable panels in galvanized steel sheet; all this brings to an excellent aesthetic impact. Weatherproof cover in galvanized steel sheet.
- Double skin panels thickness 13 mm.
- The fan is fixed by using the outlet flange and suitable brackets on the sides of the fan. The fan is completely isolated from the structure, by antivibration mounts and gaskets.
- Inside lining of the plenum in technopolymer class I.
- Double inlet fan, frontward bladed, with direct drive built-in motor, asynchronous, single-phase or three-phase, class B, suitable for speed regulation (using regulators shown in this catalogue).
- With suitable holes for lifting hooks.

ACCESSORIES

- Electronic and self-transformer speed regulators.
- Feet support

UPON REQUEST

- Versions with asynchronous 3 speed motor , class B.
- Versions with totally enclosed motor, class B.

UGLOVI ISPUŠTANJA / DISCHARGE ANGLES

BOX-DR

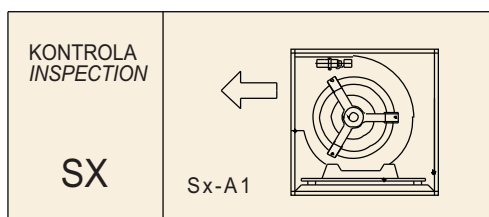

Važno: standardi uglova ispuštanja SX-A1 / Note: standard discharge angles SX-A1

Frekvencija 50 Hz - Temperatura vazduha 15°C – Barometarski pritisak 760 mm Hg – Specifična težina vazduha 1,22 Kg/m³
 Frequency 50Hz – Air temperature 15°C – Barometric pressure 760 mm Hg – Air specific weight 1,22 Kg/m³

BOX-D - 4 pola/poles

Tip Type	Model Model	U	P	Pm (kW)	In max (A)	Lp dB(A)	Reg.
BOX-D	3/8 B	M	4	0,04	0,5	45	RV/1 o RVM/2
BOX-D	7/7 B	M	4	0,14	2	57	RV/1 o RVM/2
BOX-D	9/7 B	M	4	0,37	5	62	RV/2 o RVM/3
BOX-D	9/9 B	M	4	0,37	4,5	62	RV/2 o RVM/3
BOX-D	10/8 B	M	4	0,55	6,7	63	RV/2 o RVM/3
BOX-D	10/10 B	M	4	0,55	6,5	64	RV/2 o RVM/3

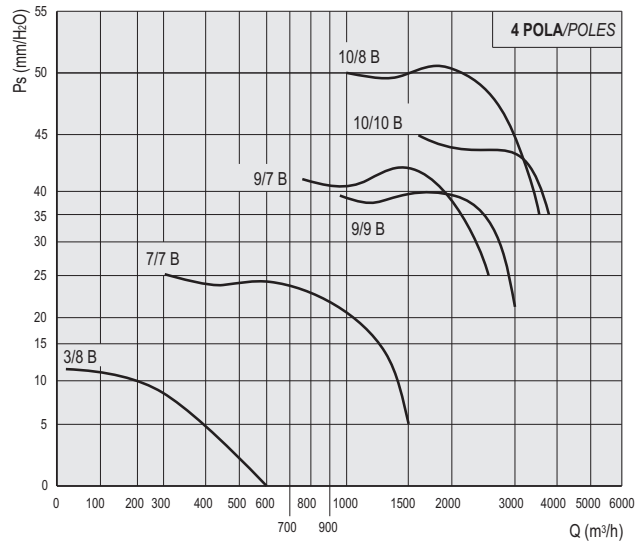

BOX-D - 6 pola/poles

Tip Type	Model Model	U	P	Pm (kW)	In max (A)	Lp dB(A)	Reg.
BOX-D	7/7 A	M	6	0,06	1,1	51	RV/N o RVM
BOX-D	9/7 A	M	6	0,14	2	54	RV/1 o RVM/2
BOX-D	9/9 A	M	6	0,24	2,6	56	RV/1 o RVM/2
BOX-D	10/8 A	M	6	0,24	2,6	56	RV/1 o RVM/2
BOX-D	10/10 A	M	6	0,24	3	56	RV/1 o RVM/2

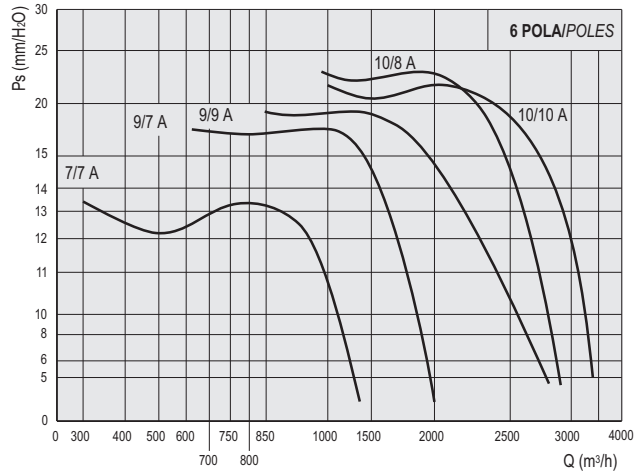

BOX-D - 6 pola/poles

Tip Type	Model Model	U	P	Pm (kW)	In max (A)	Lp dB(A)	Reg.
BOX-D	12/9 A	M	6	0,59	6,7	59	RV/2 o RVM/3
BOX-D	12/12 A	M	6	0,59	7	64	RV/2 o RVM/3

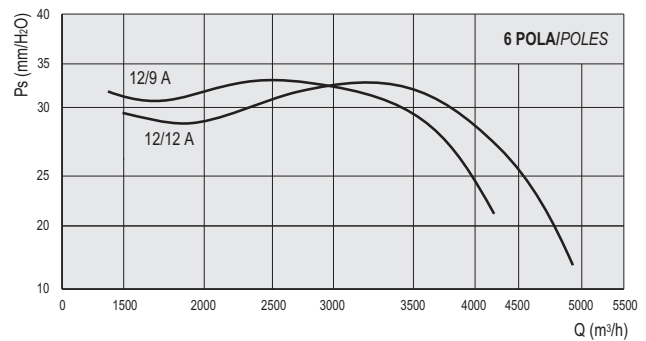

BOX-D - 6 pola/poles

Tip Type	Model Model	U	P	Pm (kW)	In max (A)	Lp dB(A)	Reg.
BOX-D	12/9 A T	T	6	1,1	4,3	68	RVT/1
BOX-D	12/12 A T	T	6	1,1	4,7	70	RVT/1

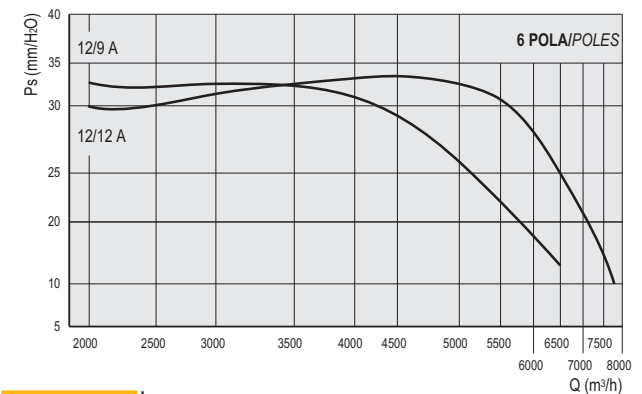

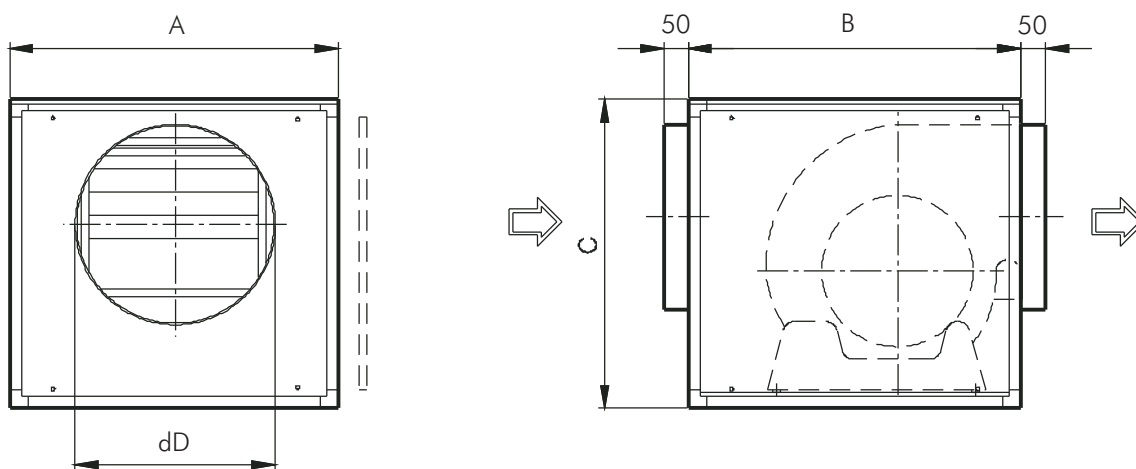

Veličina	k W	A	B	C	d D	K g
7 / 7	0 . 1 4	4 2 0	4 2 0	4 2 0	2 5 0	2 4
9 / 7	0 . 3 7	5 0 0	5 0 0	5 0 0	3 1 5	2 8
9 / 9	0 . 3 7	5 0 0	5 0 0	5 0 0	3 5 5	3 3
1 0 / 8	0 . 5 5	6 0 0	6 0 0	6 0 0	4 0 0	3 5
1 0 / 1 0	0 . 5 5	6 0 0	6 0 0	6 0 0	4 5 0	3 6
1 2 / 9	0 . 5 5	7 5 0	6 4 0	6 4 0	4 5 0	6 5
1 2 / 1 2	0 . 5 5	7 5 0	6 4 0	6 4 0	4 5 0	6 6

Dimenzije u mm/Dimensions in mm

