

# MINI-REC

## Rekuperator toplote Heat recuperator

### OSNOVNI PODACI :

Jedinice za obnavljanje toplote iz serije MINI-REC su dizajnirane i proizvedene da rešavaju problem visoke potrošnje energije, koje su tipične za industrijske pogone koji koriste spoljašnji vazduh. Zahvaljujući postojanju razmenjivača toplote, moguće je povratiti 50% energije koja bi inače bila izgubljena isterivanjem iskorišćenog vazduha. MINI-REC uređaji se mogu integrisati u bilo koji sistem ventilacije i održavanja vazduha, a tako mogu raditi zajedno u letnjoj i zimskoj sezoni. Pogodni su za ugradnju u plafon i priključivanje na kanalne-cevne sisteme. Omogućuju izvlačenje i uvlačenje vazduha direktno u prostoriju-okolinu.

### KONSTRUKCIJA :

**NOSEĆA KONSTRUKCIJA:** je napravljena od panela galvanizovane čelične ploče sa akustičnom izolacijom debljine (10mm). Na ulaznom otvoru je panel sa filterom koji se lako može postaviti u slučaju zamene.

Sve komponente su ispitivane i lako se uklanjaju sa osnove.

#### NADOKNADA TOPLOTE

Statični tip obnavljača toplote sa poprečnim protokom, visoke je efikasnosti. Ploče od aluminijuma sa protocima koji su odvojeni odgovarajućim zaptivačima. Ispod obnavljačke jedinice je montirano kućište za sakupljanje kondenzata, odvodne cevi su od NERĐAJUĆEG čelika.

#### FILTER VAZDUHA

Filter se sastoji od valovitih pregrada sa mogućnošću zamene sa osnove, sa filterom u sredini od sintetičkog vlakna klase G3 ( Procenjena efikasnost 85%-EU3).

### GENERAL DESCRIPTION

The heat recovery units of the MINI-REC series are designed and realized to solve the problem of the high consumption of energy, typical of all the plants supplying outside air. Thanks to the presence of a heat exchanger, it is possible to recover more than the 50% of the energy which would otherwise be lost with the expulsion of the spoiled air. The MINI-REC units can be fitted in addition to every systems of ventilation and conditioning and they can work both in the summer and winter seasons.

They are particularly suitable for ceiling installations and ducting, allowing the exhaust and the introduction of supply air directly in the environment.

### CONSTRUCTION

**MAIN STRUCTURE:** the main structure is realized with panels in galvanized steel sheet with acoustic insulation (thickness of 10 mm).

The inlet side filter housing panel can be easily replaced for installation needs. All the components are examinable and can be easily removed from the bottom.

**HEAT RECOVERY:** the heat recovery of the static type with crossed flow high efficiency. The plates are in aluminium with the flows kept separated by suitable sealing. Under the recovery unit is installed a condensate collection plate in STAINLESS steel with draining pipe connection.

**AIR FILTER:** the filters are of the cell type with wavy septum removable from the bottom and reusable, with filtering media in synthetic fibre class G3 (Pondered efficiency 85%-EU3).

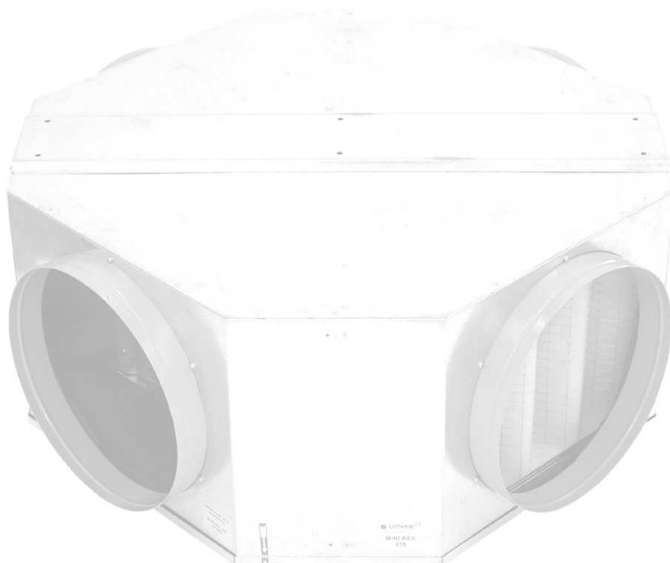
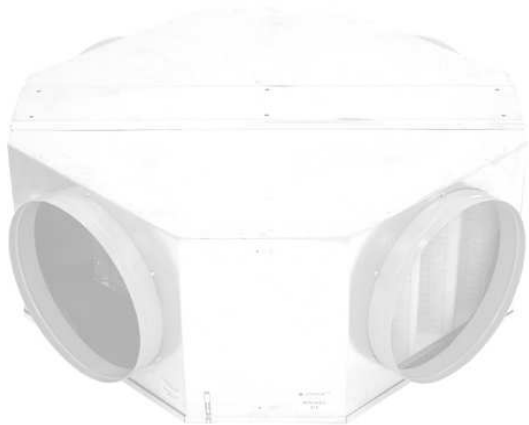

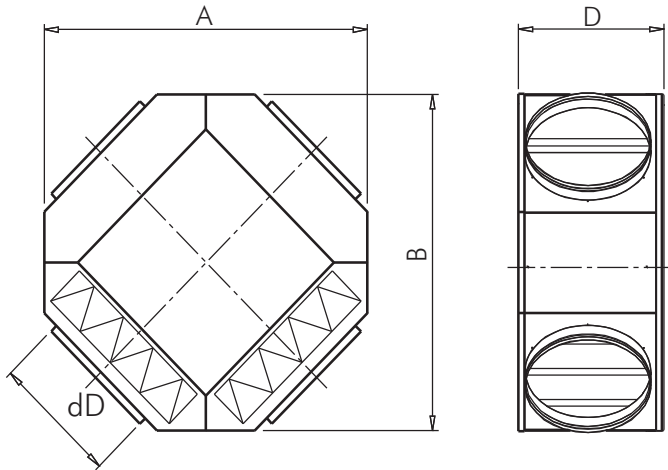

Tip /Type	A	B	C	dD	kg
200	720	720	20	230	24
315	800	800	315	360	30

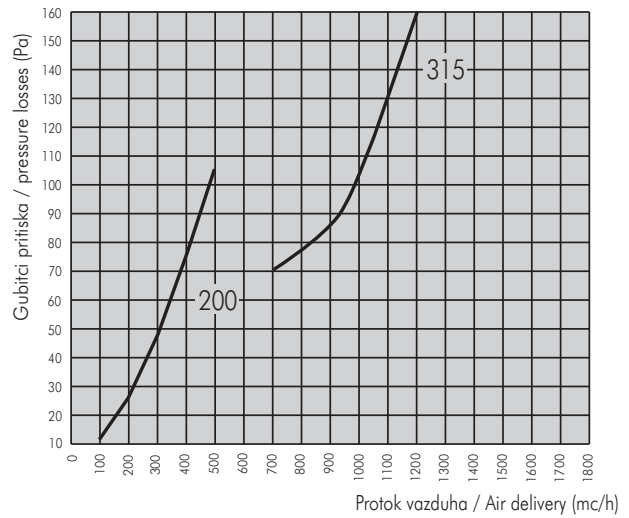
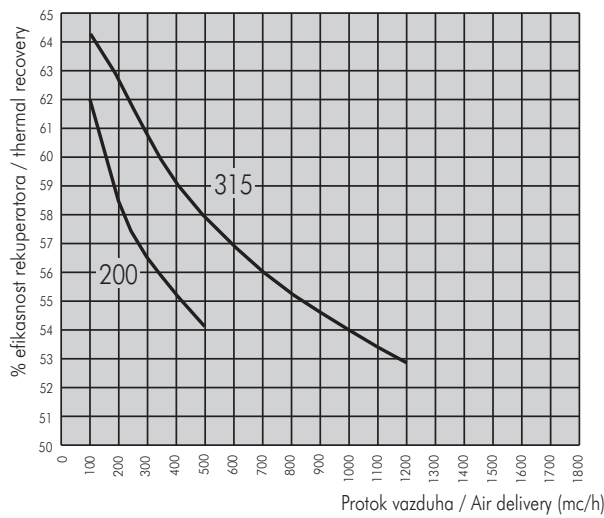

UREĐAJ / APPLICATION

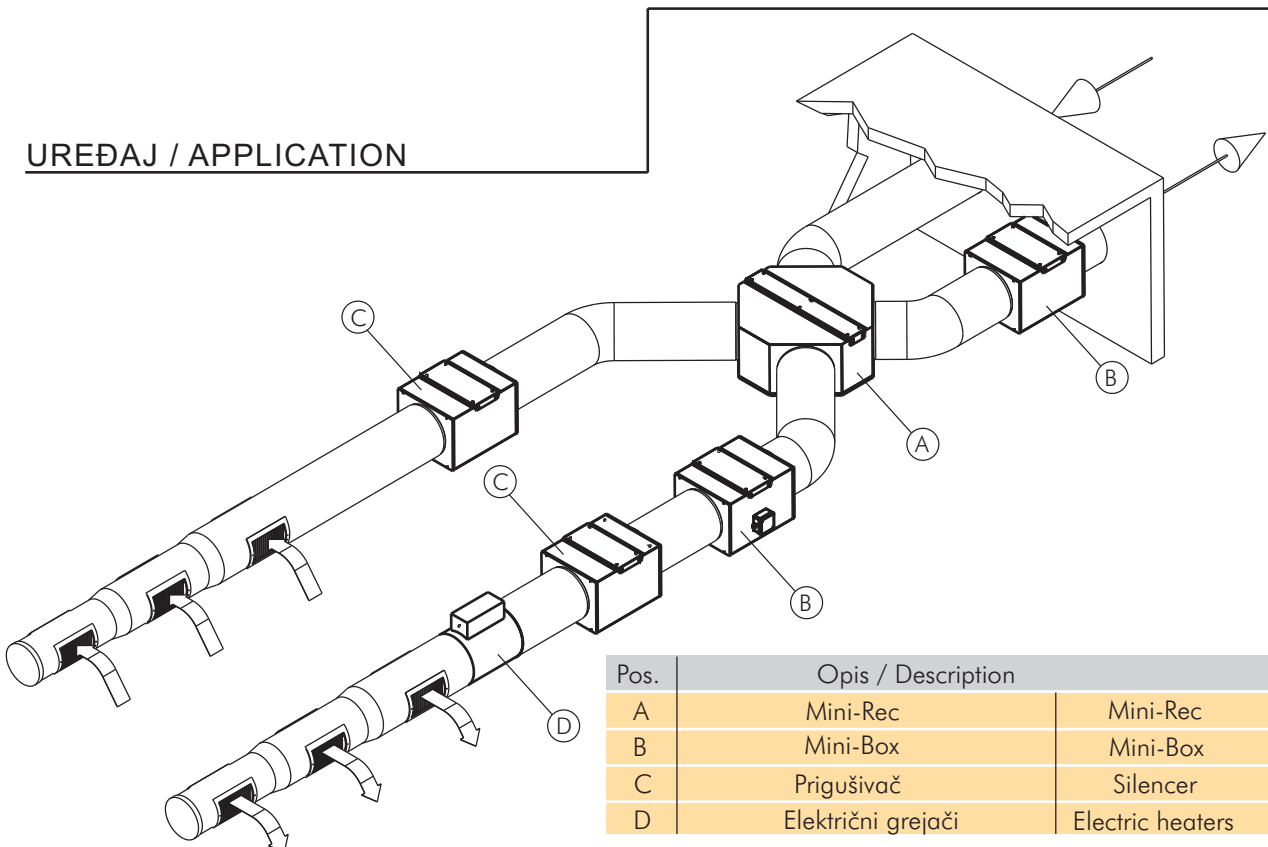

Pos.	Opis / Description	
A	Mini-Rec	Mini-Rec
B	Mini-Box	Mini-Box
C	Prigušivač	Silencer
D	Električni grejači	Electric heaters